



## Alaska Alcoholic Beverage Control Board

**Form AB-01: Transfer License Application****Why is this form needed?**

This transfer license application form is required for all individuals or entities seeking to apply for the transfer of ownership and/or location of an existing liquor license. Applicants should review **Title 04 of Alaska Statutes** and **Chapter 304 of the Alaska Administrative Code**. All fields of this form must be completed, per AS 04.11.260, AS 04.11.280, AS 04.11.290, and 3 AAC 304.105.

**This form must be completed and submitted to AMCO's Anchorage office, along with all other required forms and documents, before any license application will be considered complete.**

**Section 1 – Transferor Information**

Enter information for the **current** licensee and licensed establishment.

Licensee:	El Pastor LLC	License #:	5954		
License Type:	Restaurant/Eating Place	Statutory Reference:	AS 04.09.210		
Doing Business As:	El Pastor				
Premises Address:	12300 Old Glenn Hwy				
City:	Eagle River	State:	Alaska	ZIP:	99577
Local Governing Body:	Municipality of Anchorage				

**Transfer Type:**

Regular transfer



Transfer with security interest



Involuntary retransfer

**OFFICE USE ONLY**

Complete Date:		Transaction #:	
Board Meeting Date:		License Years:	
Issue Date:		Examiner:	



## Alaska Alcoholic Beverage Control Board

**Form AB-01: Transfer License Application****Section 2 – Transferee Information**Enter information for the **new** applicant and/or location seeking to be licensed.

Licensee:	J&A Group Inc				
Doing Business As:	El Pastor				
Premises Address:	12300 Old Glenn Hwy				
City:	Eagle River	State:	Alaska	ZIP:	99577
Community Council:	Eagle River Valley				

Mailing Address:	12300 Old Glenn Hwy				
City:	Eagle River	State:	Alaska	ZIP:	99577

Designated Licensee:	Jesus Gallardo de la Torre				
Contact Phone:	907-903-8564	Business Phone:	907-726-0511		
Contact Email:	elpastorak96@gmail.com				

Seasonal License?    Yes ☐    No ☒    If "Yes", write your six-month operating period: \_\_\_\_\_

**Section 3 – Premises Information**

Premises to be licensed is:

☒ an existing facility    ☐ a new building    ☐ a proposed building

The next two questions must be completed by beverage dispensary (including tourism) and package store applicants only:

What is the distance of the shortest pedestrian route from the public entrance of the building of your proposed premises to the outer boundaries of the nearest school grounds? Include the unit of measurement in your answer.

What is the distance of the shortest pedestrian route from the public entrance of the building of your proposed premises to the public entrance of the nearest church building? Include the unit of measurement in your answer.



Alaska Alcoholic Beverage Control Board

## Form AB-01: Transfer License Application

### Section 4 – Sole Proprietor Ownership Information

This section must be completed by any sole proprietor who is applying for a license. Entities should skip to Section 5.  
If more space is needed, please attach a separate sheet with the required information.  
The following information must be completed for each licensee and each affiliate (spouse).

This individual is an: ☐ applicant ☐ affiliate

Name:					
Address:					
City:		State:		ZIP:	

This individual is an: ☐ applicant ☐ affiliate

Name:					
Address:					
City:		State:		ZIP:	

### Section 5 – Entity Ownership Information

This section must be completed by any entity, including a corporation, limited liability company (LLC), partnership, or limited partnership, that is applying for a license. Sole proprietors should skip to Section 6.

If more space is needed, please attach a separate sheet with the required information.

- If the applicant is a corporation, the following information must be completed for each *stockholder who owns 10% or more* of the stock in the corporation, and for each *president, vice-president, secretary, and managing officer*.
- If the applicant is a limited liability organization, the following information must be completed for each *member with an ownership interest of 10% or more*, and for each *manager*.
- If the applicant is a partnership, including a limited partnership, the following information must be completed for each *partner with an interest of 10% or more*, and for each *general partner*.

Entity Official:	Jesus Gallardo de la Torre				
Title(s):	Director, President, Shareholder, Treasurer	Phone:	907-903-8564	% Owned:	60
Address:	2684 Lauren Creek Loop				
City:	Anchorage	State:	Alaska	ZIP:	99507



## Alaska Alcoholic Beverage Control Board

**Form AB-01: Transfer License Application**

Entity Official:	Ana Maria Romo Gutierrez				
Title(s):	Assistant Treasurer, Secretary, Shareholder, Vice President	Phone:	907-308-0450	% Owned:	40
Address:	2684 Lauren Creek Loop				
City:	Anchorage	State:	Alaska	ZIP:	99507

Entity Official:					
Title(s):		Phone:		% Owned:	
Address:					
City:		State:		ZIP:	

Entity Official:					
Title(s):		Phone:		% Owned:	
Address:					
City:		State:		ZIP:	

This subsection must be completed by any applicant that is a corporation or LLC. Corporations and LLCs are required to be in good standing with the Alaska Division of Corporations (DOC) and have a registered agent who is an individual resident of the state of Alaska.

DOC Entity #:	10238796	AK Formed Date:	07/11/2023	Home State:	Alaska
Registered Agent:	Jesus Gallardo de la Torre	Agent's Phone:	907-903-8564		
Agent's Mailing Address:	elpastorak96@gmail.com				
City:	Eagle River	State:	Alaska	ZIP:	99577

Residency of Agent:

Yes No

Is your corporation or LLC's registered agent an individual resident of the state of Alaska?







Alaska Alcoholic Beverage Control Board

**Form AB-01: Transfer License Application**

**Section 6 – Other Licenses**

Ownership and financial interest in other alcoholic beverage businesses:

Yes

No

Does any representative or owner named as a transferee in this application have any direct or indirect financial interest in any other alcoholic beverage business that does business in or is licensed in Alaska?

☐☒

If "Yes", disclose which individual(s) has the financial interest, what the type of business is, and if licensed in Alaska, which license number(s) and license type(s):

**Section 7 – Authorization**

Communication with AMCO staff:

Yes

No

Does any person other than a licensee named in this application have authority to discuss this license with AMCO staff?

☐☒

If "Yes", disclose the name of the individual and the reason for this authorization:



Alaska Alcoholic Beverage Control Board

**Form AB-01: Transfer License Application**

**Section 8 – Transferor Certifications**

Additional copies of this page may be attached, as needed, for the controlling interest of the current licensee to be represented.

I declare under penalty of perjury that the undersigned represents a **controlling interest** of the current licensee. I additionally certify that I, as the current licensee (either the sole proprietor or the controlling interest of the currently licensed entity) have examined this application, approve of the transfer of this license, and find the information on this application to be true, correct, and complete.

  
\_\_\_\_\_  
Signature of transferor

**Jesus Gallardo de la Torre**  
\_\_\_\_\_  
Printed name of transferor

Subscribed and sworn to before me this 30 day of September, 2024.

  
\_\_\_\_\_  
Signature of Notary Public

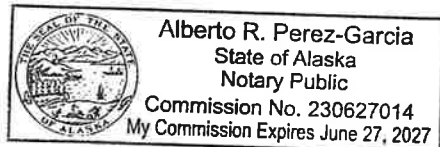

Notary Public in and for the State of Alaska

My commission expires: June 27, 2027

  
\_\_\_\_\_  
Signature of transferor

**Cesar Gutierrez Romo**  
\_\_\_\_\_  
Printed name of transferor

Subscribed and sworn to before me this 30 day of September, 2024.

  
\_\_\_\_\_  
Signature of Notary Public

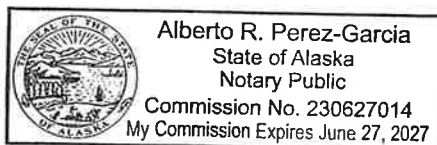

Notary Public in and for the State of Alaska

My commission expires: June 27, 2027



Alaska Alcoholic Beverage Control Board

Form AB-01: Transfer License Application

Section 9 – Transferee Certifications

Read each line below, and then sign your initials in the box to the right of each statement:

Initials

I certify that all proposed licensees (as defined in AS 04.11.260) and affiliates have been listed on this application.

JG

I certify that all proposed licensees have been listed with the Division of Corporations.

JG

I certify that I understand that providing a false statement on this form or any other form provided by AMCO is grounds for rejection or denial of this application or revocation of any license issued.

JG

I certify that all licensees, agents, and employees who sell or serve alcoholic beverages or check the identification of a patron will complete an approved alcohol server education course, if required by AS 04.21.025, and, while selling or serving alcoholic beverages, will carry or have available to show a current course card or a photocopy of the card certifying completion of approved alcohol server education course, if required by 3 AAC 304.465.

JG

I agree to provide all information required by the Alcoholic Beverage Control Board in support of this application.

JG

I hereby certify that I am the person herein named and subscribing to this application and that I have read the complete application, and I know the full content thereof. I declare that all of the information contained herein, and evidence or other documents submitted are true and correct. I understand that any falsification or misrepresentation of any item or response in this application, or any attachment, or documents to support this application, is sufficient grounds for denying or revoking a license/permit. I further understand that it is a Class A misdemeanor under Alaska Statute 11.56.210 to falsify an application and commit the crime of unsworn falsification.

JG

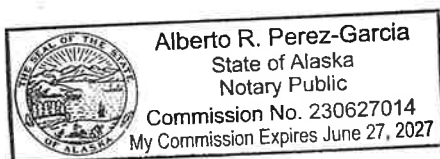

Alberto R. Perez-Garcia

State of Alaska

Notary Public

Commission No. 230627014

My Commission Expires June 27, 2027

Signature of transferee

Jesus Gallardo de la Torre

Printed name

Signature of Notary Public

Notary Public in and for the State of Alaska

My commission expires: June 27, 2027

Subscribed and sworn to before me this 30 day of September, 2024.



## Alaska Alcoholic Beverage Control Board Form AB-02: Premises Diagram



### Why is this form needed?

A detailed diagram of the proposed licensed premises is required for all alcohol license applications, per AS 04.11.260, 3 AAC 305.630 and 3 AAC 305.660. Your diagram must include dimensions and must show all entrances and boundaries of the premises, walls, bars, fixtures, and areas of storage, service, consumption, and manufacturing.

**This form must be completed and submitted to AMCO's Anchorage office before any license application will be considered complete. You may attach blueprints or other detailed drawings that meet the requirements of this form.**

### The diagram MUST include:

- You must use a **solid, contiguous red line** to outline the outer perimeter of your premises with no breaks or separations.
  - The red outline is required to follow a physical barrier (wall, fence and even across doorways).
  - There should be no red lines within the perimeter.
- Each area should be clearly labeled in any color other than red where alcohol is:
  - Stored
  - Served/Sold
  - Manufactured
  - Consumed
- All diagrams must include:
  - Dimensions (AMCO does not accept diagrams drawn to scale)
  - Cross streets
  - Points of reference, such as a compass rose indicating True North
  - All entrances, exits, walls, bars, and fixtures
- If your premises include multiple floors, please include a separate diagram of each floor.
  - You must identify the stairs between each floor, and each hallway/corridor that leads to each set of stairs.
- If your premises includes multiple floors, please include a separate diagram of each floor. You must identify the stairs between each floor, and each hallway/corridor that leads to each set of stairs.
- If your proposed premises is located within a building or building complex that contains multiple businesses and/or tenants, please provide an additional page that clearly shows the location of your proposed premises within the building or building complex, along with the addresses and/or suite numbers of the other businesses and/or tenants within the building or building complex.
- Any license applications that include outdoor space** are required to submit a security plan that includes information about the barriers, practices, and personnel that are to be used to ensure that alcohol is not introduced or removed from the permitted premises and to prevent the access of alcohol by a minor during the permitted event. A security plan may be requested for other proposed locations on a case-by-case basis.

## Section 1 – Establishment Information

Enter information for the business seeking to be licensed, as identified on the license application.

Licensee:	J&A Group Inc	License Number:	5954
License Type:	Restaurant/Eating Place		
Doing Business As:	El Pastor		
Premises Address:	12300 Old Glenn Hwy		
City:	Eagle River	State:	Alaska
		ZIP:	99577



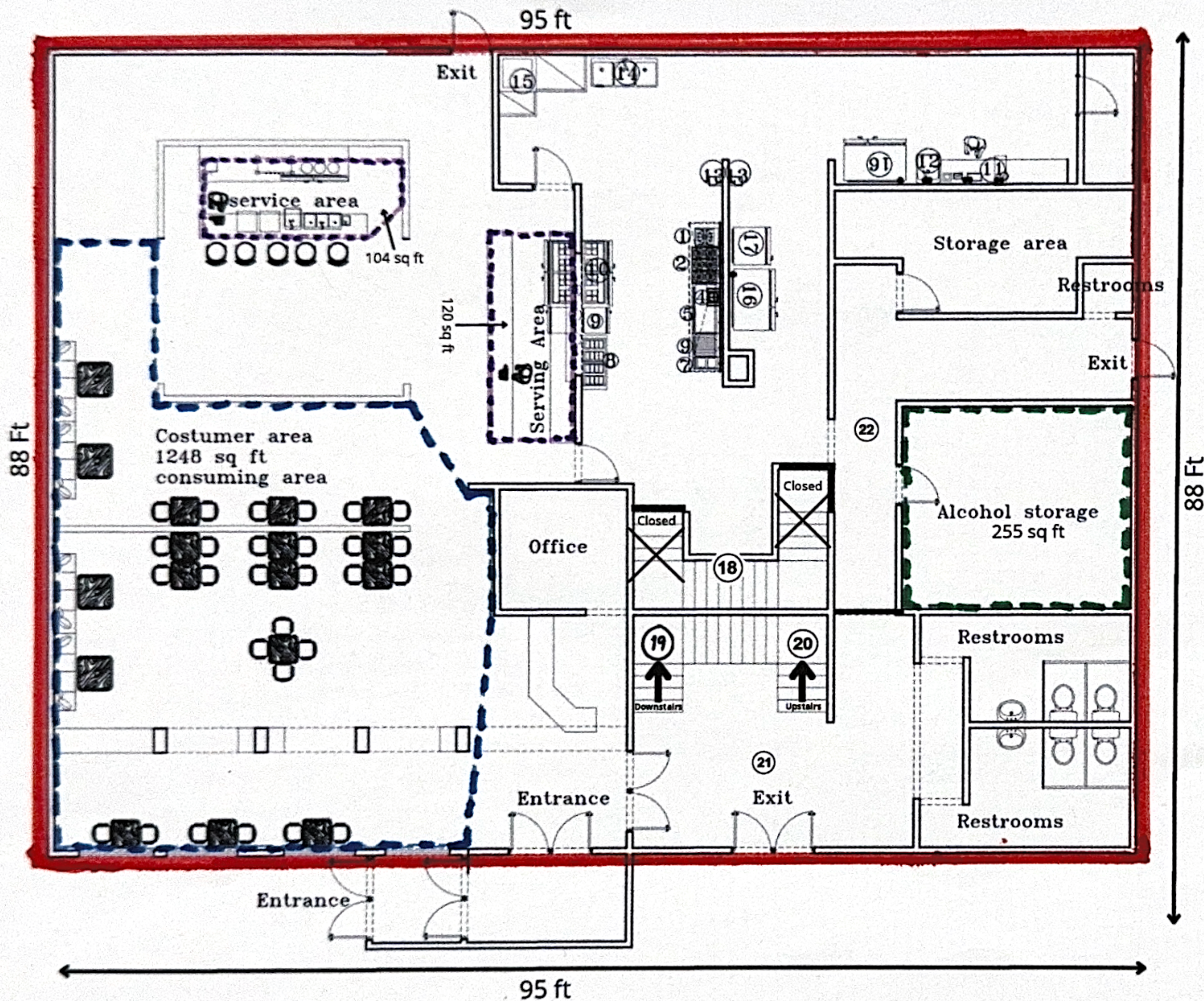

Service Area  
 Costumer area  
 Alcohol storage

1	POT STOVE	12X24X24
2	SIX BURNER STOVE	40X36X36
3	SALAMANDER BROILER	24X20X20
4	VENTILATION HOOD	144X48X30
5	FLAT GRILL	48X36X36
6	GRILL	24X36X36
7	FRYER	12X60X36
8	STEAM TABLE	48X25X36
9	BAKERY FRIDGE	
10	SANDWICH PREPARATION REFRIGERATOR	145X36X36
11	PREP STATION	
12	FOOD PREPARATION SINK	24x36x36
13	HAND SINK	12x18
14	3 COMPARTMENT SINK	62x36x36
15	DISHWASHER	36X36X62
16	REFRIGERATOR	
17	FREEZER	24X24X6
18	Closed Stairs with a wall not in use	
19	Stairs to the first floor, not part of the restaurant. (storage of landlord) No public access is closed with a fence.	
20	Stairs to third floor, not part of the restaurant, not in use. Closed	
21	Corridor to restrooms	
22	Corridor that connects storage rooms and kitchen	



Chugach Eye Clinic  
 Meghans Tax Service  
 Eagle River Driving School  
 Country Financial

Old Glenn Hwy





## For Restaurant Information for REPL License Type

Alcohol and Marijuana Control Office

550 W 7<sup>th</sup> Avenue, Suite 1600

Anchorage, AK 99501

[alcohol.licensing@alaska.gov](mailto:alcohol.licensing@alaska.gov)

<https://www.commerce.alaska.gov/web/amco>

Phone: 907.269.0350

### Alaska Alcoholic Beverage Control Board

## Restaurant Endorsement Application

The new endorsement application form is required to apply for a restaurant endorsement to support your underlying license or pending license application. Applicants should review and become familiar with AS 04.09.450, **Title 04 of Alaska Statutes and Chapter 305 of the Alaska Administrative Code**. This form must be completed and submitted along with all other required forms and documents before any endorsement application will be considered complete and placed in the queue for our licensing examiners review.

### Section 1 – Establishment and Contact Information

Enter information for the **current** licensee and licensed establish.

Licensee:	J&A Group Inc	License #:	5954		
License Type:	Restaurant/Eating Place	Doing Business As:	El Pastor		
Licensee Mailing Address:	12300 Old Glenn Hwy, Eagle River Alaska 99577				
Full Premises Address:	12300 Old Glenn Hwy				
City:	Eagle River	State:	Alaska	ZIP:	99577
Local Governing Body:	Municipality of Anchorage	Email:	elpastorak96@gmail.com		

### Section 2 – Endorsement Requested

Restaurant Endorsement:	<b>AS 04.09.450.</b> A restaurant endorsement authorizes the holder of a beverage dispensary license, fair license, golf course license, sporting activity or event license, club license, outdoor recreation lodge license, destination resort license, or beverage dispensary tourism license. The biennial fee for a restaurant endorsement is \$200 with a \$25 application fee.
-------------------------	---

An application for a restaurant endorsement must specify the establishment or portion of the establishment that constitutes a bona fide restaurant, that there is supervision on the premises adequate to reasonably ensure that a person under 21 years of age will not obtain alcoholic beverages. This **endorsement** application is for the request of a designation as a bona fide restaurant, hotel, or eating place for purposes of AS 04.16.010(c) or AS 04.16.049, and for the request of the following designation(s) (check all that apply):

- ☐ Dining after standard closing hours: AS 04.16.010(c)
- ☒ Dining by persons 16 – 20 years of age: AS 04.16.049(a)
- ☒ Dining by persons under the age of 16 years, accompanied by a person over the age of 21: AS 04.16.049(a)
- ☒ Employment for any persons under 21 years of age: AS 04.16.049(c)

**NOTE:** Under AS 04.16.049(d), a Department of Labor and Workforce Development work permit is not required to employ a person 18 - 20 years of age.

### Section 3 – Minor Access

Review AS 04.16.049(a); AS 04.16.049(c)

Be specific in your list where within the premises minors are anticipated to have access in the course of either dining or employment as designated in Section 2. (Example: Minors will only be allowed in the dining area OR minors will only be employed and present in the kitchen).

Dining Area: Minors who come to the establishment for dining will only be allowed in the designated dining area. They will not have access to any area where alcohol is being served or stored, except for passing through

Work Area (for minors employed): Minors who are employed by the establishment will be allowed to work in the kitchen or other designated work areas. They will not be allowed to handle or serve alcohol at any time and will not have access to areas where alcohol is store or served to customers, except when performing duties that do not involve alcohol (e.g., cleaning or passing through).



## Alaska Alcoholic Beverage Control Board Restaurant Endorsement Application

Describe the policies, practices and procedures that will be in place to ensure that minors do not gain access to alcohol while dining or employed at your premises. Outline how and where alcohol is stored on premises. Acknowledge that employees who sell and serve alcohol must have a current Server Education Card.

Checks ID's, Bands or stams System for large groups, Keep our staff Educate, create and enforcement policy. The Beer & Wine will be store in a designated an locked storage.

Is an owner, manager, or assistant manager who is 21 years of age or older always present on the premises during business hours?



### Section 4 – ADEC Food Service Permit

Per AS 04.21.080(b) for an establishment to qualify as a bona fide restaurant, a Food Service Permit or (for licenses within the Municipality of Anchorage) corresponding Department of Health and Human Services documentation is required.

Link to the Alaska Department of Environmental Conservation (ADEC) Food Safety Website:

<http://dec.alaska.gov/eh/fss/food/>

Link to the Municipality of Anchorage Food Safety Website:

<http://www.muni.org/Departments/health/Admin/environment/FSS/Pages/fssfood.aspx>

IF you are unable to certify the below statement, please discuss the matter with the AMCO office:

I have attached a copy of the current food service permit for this premises OR the plan review approval.

Initials  
**JG**

**\*Note:** If a plan review approval is submitted, a final permit will be required before finalization of any permit or license application.

### Section 5 – Hours of Operation

Review AS 04.16.010(c).

Include variances in weekend/weekday hours, and indicate AM/PM:

Days/Hours of Operation

Weekday	Hours	Hours
Sunday	8:00 AM	8:00 PM
Monday	9:00 AM	8:00 PM
Tuesday	9:00 AM	9:00 PM
Wednesday	9:00 AM	9:00 PM
Thursday	9:00 AM	9:00 PM
Friday	9:00 AM	9:00 PM
Saturday	9:00 AM	9:00 PM



## Alaska Alcoholic Beverage Control Board Restaurant Endorsement Application

### Section 6 – Areas Covered by Endorsement

Does the endorsement apply to your entire licensed premises as approved by the ABC Board? Yes ☒ No ☐  
Does the requested endorsement expand your currently licensed premises? Yes ☐ No ☒

- If No, attach the approved diagram, no larger than 8 1/2" x 11" of the layout, and identify the portions of the premises covered by various requested endorsements. You must use a solid, contiguous colored line in any color other than red to outline the outer perimeter of the area of the premises covered by the requested endorsement(s).
- If endorsements are overlapping, provide a conspicuous means to distinguish each endorsement from the other (e.g., keyed map with varying colors for each requested endorsement).
- Your drawing MUST include:
  - Dimensions in feet **not** square feet of all exterior walls and major interior walls (we do not accept diagrams drawn to scale)
  - Include cross-streets
  - A north arrow, and any significant geographical features. Points of reference, such as a compass showing North.
  - All entrances, exits, walls, bars, and fixtures
- If your premises includes multiple floors, please include a separate diagram of each floor. You must identify the stairs between each floor, and each hallway/corridor that leads to each set of stairs.
- **Any endorsement applications that include outdoor space** are required to submit a security plan that includes information about the barriers, practices, and personnel that are to be used to ensure that alcohol is not introduced or removed from the permitted premises and to prevent the access of alcohol by a minor during the permitted event. A security plan may be requested for other proposed locations on a case-by-case basis.

### Section 7 – Attestations

I certify that I understand that providing a false statement on this form or any other form provided by AMCO is grounds for rejection or denial of this application or revocation of any license issued.

Initials  
JG

I certify that all licensees, agents, and employees who sell or serve alcoholic beverages or check the identification of a patron will complete an approved alcohol server education course, if required by AS 04.21.025, and while selling or serving alcoholic beverages, will carry or have available to show a current course card or a photocopy of the card certifying completion of approved alcohol server education course, if required by 3AAC 305.340.

JG

I agree to provide all information required by the Alcoholic Beverage Control Board in support of this application.

JG

I hereby certify that I am the person herein named and subscribing to this application and that I have read the complete application, and I know the full content thereof. I declare that all of the information contained herein, and evidence of other documents submitted are true and correct. I understand that any falsification or misrepresentation of any item or response in this application, or any attachment, or documents to support this application, is sufficient grounds for denying or revoking a license, and or endorsement. I further understand that this is a Class A misdemeanor under AS 11.56.210 to falsify an application and commit the crime of unsworn falsification.

JG

Jesus Gallardo de la Torre

Printed name of licensee

  
Signature of licensee

09/28/2024

Date

# Buenos dias

## Chilaquiles 15

Fried corn tortilla with tomatillo sauce, cheese, sour cream, served with beans and two eggs

## Huevos Rancheros 15

Two lightly fried corn tortilla with two eggs topped with sauce, served with beans

## Dos Salsas 15

Two tostadas with beans, eggs and homemade chorizo topped with lettuce, green and red sauce, sour cream and queso fresco

## Breakfast Gordita 15

Corn masa with beans, topped with eggs, lettuce, queso fresco, sauce and sour cream with a slice of bacon

## Carne Asada Hash 16

Carne asada fajitas, crispy potatoes, served with two eggs, beans and tortillas

## Lengua Breakfast 16

Lengua in green sauce, served with two eggs, beans and tortilla

## Chile Verde Breakfast 15

Slowly cooked pork shoulder with green sauce, topped with onion and cilantro, served with two eggs rice beans and tortillas

## Corned Beef Hash 16

Home made corned beef hash, served with two eggs, hash browns and toast

## All America 16

One reindeer sausage, bacon and ham served with two eggs hash browns and toast

## Adobo Hash 16

Homemade Smoked brisket hash, served with two eggs hash browns and toast

## Eggs Benedict 15

English muffin topped with ham, poached eggs and hollandaise sauce served with hash browns.

## DRINKS

Kaladi Drip Coffee 3.50

Hot Tea 3

Juice

Apple-Orange -Lemonade 4

Mimosa 8

Ask server for available Flavors

Mimosa Party 40



## BREAKFAST BURRITOS

Served with home potatoes

Filled with beans, egg, potatoes, cheese, sour cream and sauce

Steak Chorizo 13

Chile Verde 13

Reindeer 13

Asada Hash burrito 14

Steak Fajita, bell pepper and onions

## OMELETS

Served with hash browns and toast

Fajita 16

Chicken or steak fajita, Bell pepper and onion

Western 16

Ham, cheese, onion and green bell pepper

Veggie 15

Green bell pepper, onions, tomato and cheese

Reindeer & Cheese 16

Ham & Cheese 15

## TRADITIONAL BREAKFAST

Served with 2 eggs Hash brown and Toast

Bacon & eggs 14

Ham & Eggs 14

Patties & Eggs 14

## PANCAKE

Full Stack 10

Short Stack 9

PANCAKE COMBO 14

Buttermilk--Blueberry--Chocolate chips

Served with Hash Browns, two eggs, Your choice of Pork sausage, Turkey links or bacon

WAFFLE COMBO 15

Served with hash Browns, two eggs, Your choice of Pork sausage, Turkey links or bacon

## *SIDES*

Hash Browns 5

Turkey links 5

Sausage Patties 5

Reindeer Sausage 6

Bacon 6

Waffle 10

Toast 3

1 egg 2

2 eggs 4



# TACOS

## STREET TACO **5 EACH**

Soft corn tortilla ,onions, cilantro, and hot sauce.

Choose your favorite meat.

PASTOR

CARNITAS

GRILLED CHICKEN

CHICHARRON

CHORIZO

LENGUA

CARNE ASADA

CHILE VERDE

## BIRRIA TACO**5**

Soft fried corn tortilla  
with birria,  
cheese, onions,  
cilantro, and hot sauce.

## SHRIMP TACO **5.50**

Corn tortilla with  
tomatoes, red cabbage,  
cilantro and House  
dressing

## HARD SHELL AND SOFT TACO

**4 EACH**

Hard shell corn or soft flour tortilla  
with beef or chicken topped with  
lettuce salsa and Cheese



ADD RICE AND BEANS TO YOUR TACOS FOR JUST **4**

## TACO SALAD

Crispy flour tortilla bowl filled  
with beans, lettuce, tomatoes,  
cheese, sour cream, guacamole  
choice Chicken or Beef **14**

# APPETIZERS

## NACHOS **10**

Home made tortilla chips with melted  
cheese and guacamole

\*Add meat is extra

## AL PASTOR NACHOS **15**

Home made tortilla chips with beans, lettuce,  
guacamole, sour cream and cheese with you  
favorite choice of meat.

## CARNE ASADA FRIES **16**

French fries with beans, asada meat,  
melted cheese, chipotle sauce, guacamole,  
sour cream and cilantro.

## CHIPS & GUACAMOLE **10**

## CHIPS & SALSA **7**

## SIDES

Rice and beans

**6**

Chiles toreados

**3**

Half avocado

**3**

## JARRITOS **3.50**

## HORCHATA **4**

## DESSERT

FRIED ICE CREAM **5**

CHURROS **5**

FLAN **5**

BUNUELOS **5**



# EL PASTOR

BREAKFAST & TAQUERIA

12300 OLD GLENN HWY  
EAGLE RIVER, AK

99577

907-726-0511



ELPASTOR\_AK



EL PASTOR

## WE CATER

CALL US FOR INFO

AMCO Received 10/21/2024



## BURRITO

Filled with your choice of meat, rice, beans, onions, cilantro, sour cream, cheese, guacamole and salsa. **15**

AL PASTOR

CHORIZO

CARNITAS

CARNE ASADA

CHILE VERDE

GROUND BEEF

GRILLED CHICKEN

LENGUA

BIRRIA

CHICKEN CHIPOTLE **15**

With grilled onions, chipotle sauce, cheese, cilantro, rice, topped with chipotle sauce, sour cream, and cheese.

FAJITA BURRITO **15**

With beans, rice, fajita bell pepper, onions, hot sauce, sour cream, fresh guacamole and cheese. Your choice of meat:

Carne Asada or Grilled Chicken

SHRIMP CHIPOTLE **16**

With grilled onions, Chipotle sauce cheese, cilantro, rice, beans, red cabbage. Topped with chipotle sauce, sour cream, and cheese.

BURRITO SUPREME **15**

Filled with refried beans, rice your choice of meat, cheese and topped with lettuce, sour cream and enchilada sauce

## CHIMICHANGA

Deep fried burrito your choice of meat, rice, beans, and cheese topped with enchilada sauce and sour cream. **15**

## COMBO

Your choice of meat. onion, cilantro, served with rice, beans, and corn or flour tortillas **16**

AL PASTOR

CARNE ASADA

CARNITAS

GRILLED CHICKEN

CHILE VERDE

CHORIZO

BIRRIA

LENGUA

SOUP 

**15**

BOWL. 24OZ

**10**

CUP. 16OZ

## POZOLE

Shredded pork slowly cooked with hominy, chile and seasonings with cabbage, tomatoes, onions and lime

## MENUDO

Beef tripe, oregano, onion cilantro and lime

## CHICKEN SOUP

Home made chicken soup with shredded chicken, carrot, potatoes, celery, bell pepper and cabbage

## ENCHILADAS

Two corn tortilla filled with your choice of Beef, Chicken or Cheese, Topped with enchilada sauce and cheese.

With rice and beans

**13**

## ENCHILADAS SUIZAS

Corn tortilla filled with chicken, topped with green tomatillo sauce, cheese, sweet corn, avocado, sour cream.

With rice and bean

**15**

## GORDITA

Circle Fried corn masa topped with beans, queso fresco, lettuce, tomatoes, onion and hot sauce, Choice your favoritr meat. **8**

## TORTA



Mexican sandwich with guacamole, tomatoes, lettuce, hot sauce and queso fresco. Choice of meat: Al Pastor, Carnitas,

Carne Asada or Ham

**13**

Add Fries

**3**

## QUESADILLA

Two flour tortillas filled with cheese **10**

\*Add your favorite meat **13**

CORN QUESADILLA **8**

Soft fried corn tortilla with queso fresco



THIS PERMIT MUST BE CONSPICUOUSLY POSTED IN A PUBLIC PLACE IN THE ESTABLISHMENT

Municipality of Anchorage  
DEPARTMENT OF HEALTH & HUMAN SERVICES

**PERMIT**

FACILITY NAME  
OWNER'S NAME:  
LOCATION:

EL PASTOR  
J&A GROUP INC.  
12300 OLD GLENN HWY

PERMIT NO.  
FA0018782

ISSUED BY THE DEPARTMENT OF HEALTH & HUMAN SERVICES AND SUBJECT TO THE ANCHORAGE MUNICIPAL CODE OF ORDINANCES  
TITLES 15 AND 16. UNLESS THE OWNERSHIP CHANGES, THIS PERMIT IS VALID FROM 1/1/2024 TO 12/31/2024

EL PASTOR  
12300 OLD GLENN HWY  
EAGLE RIVER, AK 99577

70-031 Ver. 9\_02 \*

THIS CERTIFICATE AND PERMIT IS NOT TRANSFERABLE  
AND IS THE PROPERTY OF THE MUNICIPALITY OF ANCHORAGE

AMCO Received 10/21/2024